

**PIKASOMA**   
Mooring and Lifting

GLOBAL PARTNER FOR MOORING  
AND LIFTING SOLUTIONS

**AMBER**   
MOORING ROPES

**80%**

of all the projects are carried out outside  
the Baltic Sea region

**~300**

employees and specialists

**2100**

ships served annually

**7400**

projects worldwide

**5000**

m<sup>2</sup> of warehouse and workshop facilities

PIKASOMA started its journey in the port of Klaipeda in 1997 and is a part of GARANT GROUP international holding.

For more than 25 years Pikasoma has been implementing complete mooring and towing solutions, delivering marine supplies and everything you need for shipping, fishing industries, offshore, newbuilding and ship repair yards.

In recent years we have expanded our global warehouse network and shaped our stock to meet the specific needs of your fleet. Our expert sales managers quickly process your inquiry and support with a relevant technical advice. A team of dedicated logisticians secure a smooth delivery to the right location.

AMBER is our registered brand of high quality, reliable ship ropes. We have designed and developed AMBER ropes range to offer technologically relevant and safe solutions for your fleet.

Durable AMBER mooring ropes are easy to handle which makes maneuvering of vessels extremely accurate. The range of synthetic multipurpose ropes is available in different diameters with excellent performance indicators.



A member of

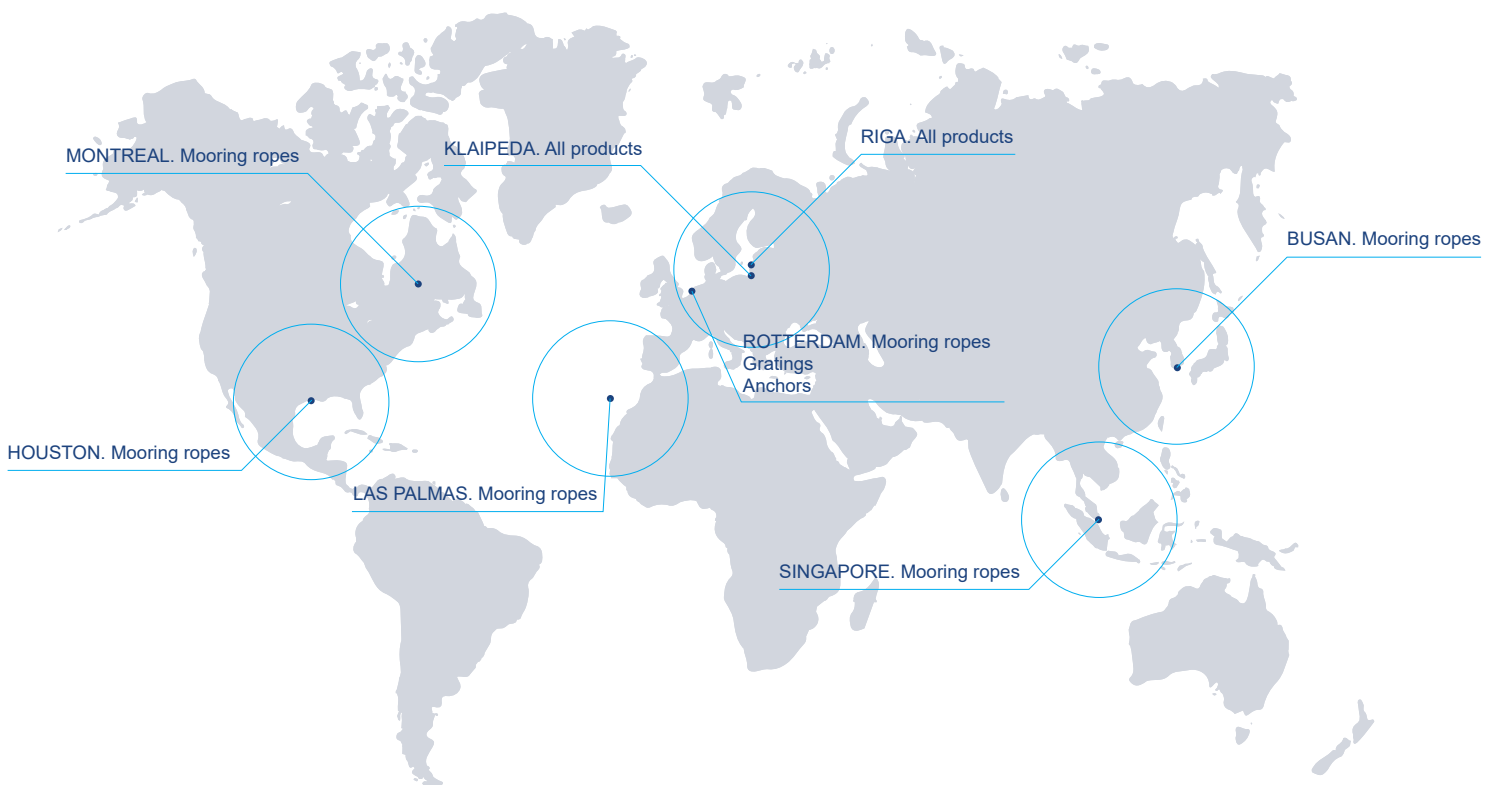

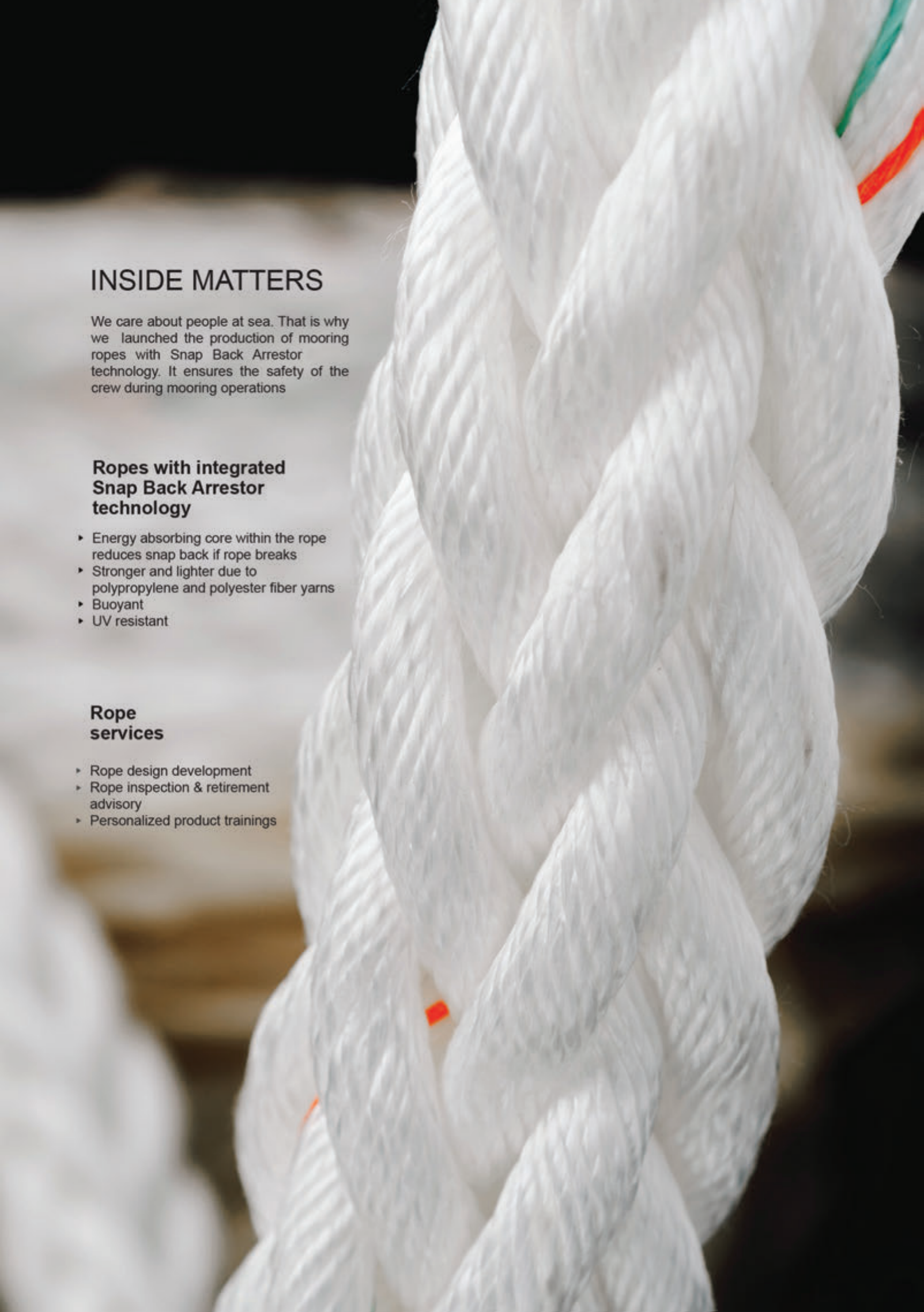

## INSIDE MATTERS

We care about people at sea. That is why we launched the production of mooring ropes with Snap Back Arrestor technology. It ensures the safety of the crew during mooring operations

### Ropes with integrated Snap Back Arrestor technology

- Energy absorbing core within the rope reduces snap back if rope breaks
- Stronger and lighter due to polypropylene and polyester fiber yarns
- Buoyant
- UV resistant

### Rope services

- Rope design development
- Rope inspection & retirement advisory
- Personalized product trainings

# AMBER MIX S

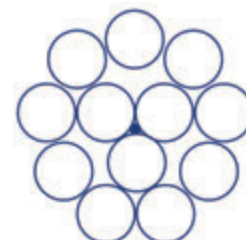

### Fiber

Combination of Polypropylene and Polyester Fiber yarns



### Construction

12-Strand plaited regular lay with Anti-Snap Back rope in the core



### Specific gravity

0.98 (floating)



### Elongation

17-20%



### Melting point

165°C



### UV resistance

Excellent



### Abrasion resistance

Excellent



### Application

Mooring, towing, anchor line, shock line, slings etc.

### Features

Integrated Snap Back Arrestor technology. Reduces snap back if rope breaks

Ensures safe mooring activities

Material composition as AMBER MIX

Polypropylene and polyester fiber yarns give higher strength and lighter weight to the rope

Diameter (mm)	Circ (inch)	Weight/220m (kg)	Breaking strength (t)	LDBF MEG4 (t)
40	5	165	33.2	29.88
44	5-1/2	195	40.2	36.18
48	6	226	47.3	42.57
50	6-1/4	247	51.5	46.36
52	6-1/2	269	55.6	50.04
56	7	309	63.8	57.42
60	7-1/2	350	72.6	63.27
64	8	401	79	71.1
68	8-1/2	454	86.7	78.03
72	9	506	97	87.3
80	10	640	117.9	106.11

The product is approved by Lloyd Register. AMBER MIX S rope is produced according to ISO9554 and tested according to ISO2307 and OCIMF MEG4.

# AMBER MIX

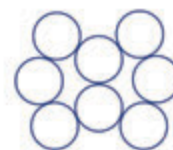

**Fiber**

High tenacity Polypropylene with outer yarns alternating with Polyester



**Construction**

8-strand braided rope



**Specific gravity**

0.99 (floating)



**Elongation**

18-20%



**Melting point**

165°C



**UV resistance**

Excellent



**Abrasion resistance**

Excellent



**Application**

Mooring, towing, anchor line, shock line, slings etc.

**Features**

Polypropylene and polyester fiber yarns give higher strength and lighter weight to the rope. It has a great value among the customers for its quality, durability and performance indicators

Diameter (mm)	Circ (inch)	Weight/220m (kg)	Breaking strength (t)	LDBF MEG4 (t)
40	5	165	33.2	30.0
44	5-1/2	195	40.2	36.2
48	6	226	47.3	42.6
50	6-1/4	247	51.5	46.4
52	6-1/2	269	55.6	50.0
56	7	309	63.8	57.4
60	7-1/2	350	72.6	65.3
64	8	401	82.5	74.2
66	8-1/16	427.7	87.8	79.0
68	8-1/2	454	93.0	83.7
72	9	506	103.9	93.5
80	10	640	127.6	114.8

All products are produced in accordance with OCIMF guidelines and IACS approved

**AMBER**  **ULTRA S**

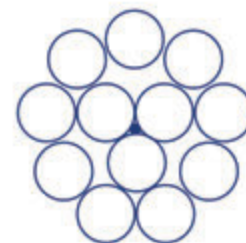

**Fiber**  
UHMWPE, Nylon



**Melting point**  
150°C



**Construction**  
12-Strand UHMWPE rope with Anti-Snap Back rope in the core



**UV resistance**  
Very good



**Specific gravity**  
0.97 (floating)



**Abrasion resistance**  
Very good



**Elongation**  
3.5%-4%



**Application**  
Mooring, towing, anchor line, shock line, slings etc

**Features**

Integrated Snap Back Arrestor technology. The Snap Back Arrestor is an energy absorbing core within the rope

Material composition as AMBER ULTRA

Reduces snap back if rope breaks

Ensures safe mooring activities

Low water absorption. Remains light when working in wet conditions

Buoyant

UV resistant

Diameter (mm)	Circ (inch)	Weight/220m (kg)	Breaking strength (t)	MBL (t)	LDBF (t)
28	3-1/2	91.3	56.92	56.92	51.23
30	3-3/4	107.8	66.1	66.1	59.49
32	4	122.1	74.66	74.66	67.19
34	4-1/4	136.4	83.23	83.23	74.91
36	4-1/2	155.1	93.94	93.94	84.55
38	4-3/4	173.8	104.65	104.65	94.19
40	5	192.5	114.75	114.75	103.28
42	5-1/4	215.97	124.85	124.85	112.37
44	5-1/2	237.97	135.86	135.86	122.27

The product is approved by Lloyd Register. AMBER ULTRA S rope is produced according to ISO 9554 and tested according to ISO 2307 and OCIMF MEG4.



**Fiber**  
UHMWPE, Urethane coated



**Construction**  
12-strand braided rope



**Specific gravity**  
0.99 (floating)



**Elongation**  
4-5%



**Melting point**  
150°C



**UV resistance**  
Excellent



**Abrasion resistance**  
Excellent



**Application**  
Mooring, towing, anchor line, shock line, slings etc.

**Features**

Wire rope replacement because of its superior strength

Diameter (mm)	Circ (inch)	Weight/220m (kg)	Breaking strength (t)	LDBF MEG4 (t)
22	2-3/4	67.1	50	45
24	3	78.9	58	52.2
26	3-1/4	90.2	66	59.4
28	3-1/2	103.4	74	66.6
30	3-3/4	114.4	81.5	73.4
32	4	125.4	88.5	79.7
34	4-1/4	137.5	96.3	86.67
36	4-1/2	149.6	104	93.6
40	5	184.4	184.8	166.3
44	5-1/2	224.4	152	136.8
48	6	266.6	179	161.1
50	6-1/4	290.4	194	174.6
52	6-1/2	310.2	206	185.4
54	6-7/8	347.6	221	198.9
56	7	358.6	236	212.4
60	7-1/2	385	252	226.8

All products are produced in accordance with OCIMF guidelines and IACS approved



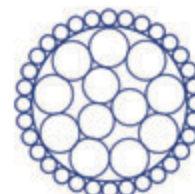

**Fiber**  
UHMWPE+ Polyester



**Construction**  
12-strand braided rope +  
outer layer cover



**Specific gravity**  
0.99-1.11 polyester jacket  
0.99 UHMWPE jacket



**Elongation**  
4-5%



**Melting point**  
150 °C UHMWPE jacket  
250 °C polyester jacket



**UV resistance**  
Excellent



**Abrasion resistance**  
Excellent



**Application**  
Mooring, towing, anchor  
line, shock line, etc.

**Features**

Ropes float in water which makes them significantly safer. Their low elongation combined with their low weight makes their handling easy and the maneuvering of vessels extremely accurate especially in distress & critical times. Polyester jacket will protect the UHMWPE rope core and prolong the service life of a rope

Diameter (mm)	Circ (inch)	Weight/220m (kg)	Breaking strength (t)	LDBF MEG4 (t)
---------------	-------------	------------------	-----------------------	---------------

22	2-3/4	68.4	38.6	34.7
24	3	81.4	46.0	41.4
26	3-1/4	95.7	54.0	48.6
28	3-1/2	112.2	63.1	56.8
30	3-3/4	128.9	68.7	61.8
32	4	143	74.2	66.8
34	4-1/4	157.8	83.6	75.2
36	4-1/2	173.8	93.0	83.7
40	5	209	114	102.6
44	5-1/2	244.2	135	121.5
48	6	301.4	165.2	148.7
50	6-1/4	327.8	179.3	161.4
52	6-1/2	354.2	195.2	175.7
54	6-7/8	378	212.6	191.3
56	7	402.6	230	207.0
60	7-1/2	451	263	236.7

All products are produced in accordance with OCIMF and MEG4 guidelines and IACS approved

**AMBER**  **WINCHLINE**

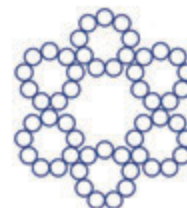

**Fiber**  
Nylon monofilament and high tenacity nylon multifilament



**Construction**  
6-strand cross lay rope + core



**Specific gravity**  
1.14



**Elongation**  
22%



**Melting point**  
218°C



**UV resistance**  
Excellent



**Abrasion resistance**  
Excellent



**Application**  
Mooring, towing, winch line, anchor line and other heavy duty applications.

**Features**

High deformation & fatigue resistance

Diameter (mm)	Circ (inch)	Weight/220m (kg)	Breaking strength (t)	LDBF MEG4 (t)
40	5	217.8	31.4	28.3
44	5-1/2	253	39.9	35.9
48	6	301.4	47.5	42.8
52	6-1/2	354.2	51.3	46.2
56	7	411.4	63.7	57.3
60	7-1/2	470.8	68.4	61.6
64	8	536.8	77.9	70.1
68	8-1/2	607.2	89.3	80.4
72	9	679.8	102.6	92.3
80	10	838.2	119.7	107.7

All products are produced in accordance with OCIMF and MEG4 guidelines and IACS approved

**AMBER**  **WINCHLINE**  
Plus

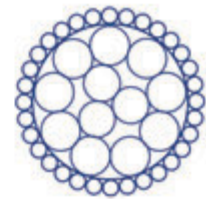
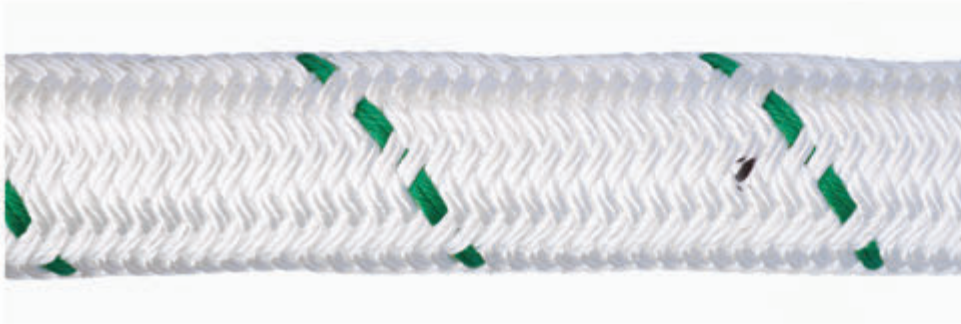

**Fiber**  
UV stabilized high tenacity polyolefin hybrid yarn



**Construction**  
12-strand braided core + outer cover layer



**Specific gravity**  
0.93 (floating)



**Elongation**  
Approx. 15%



**Melting point**  
165°C



**UV resistance**  
Good



**Abrasion resistance**  
Excellent



**Application**  
Mooring, winch line, anchor line and other heavy duty applications.

**Features**

Low elongation increases safety by minimizing risks due to snapback action. Doesn't lose strength when wet.

Diameter (mm)	Circ (inch)	Weight/220m (kg)	Breaking strength (t)	LDBF MEG4 (t)
48	6	291.5	48	43
50	6-1/4	316.4	52	47
52	6-1/2	351	59	53
56	7	401.5	65	59
60	7-1/2	440	75	68
64	8	490.6	86	77
66	8-1/16	506.9	91	82
68	8-1/2	550	95	86
72	9	617.1	106	95
80	10	792	130	117

All products are produced in accordance with OCIMF and MEG4 guidelines and IACS approved

## Mooring tails



### Fiber

High tenacity Polypropylene with outer yarns alternating with Polyester



### Construction

8-strand braided rope



### Specific gravity

0.99 (floating)



### Elongation

18-20%



### Melting point

165°C



### UV resistance

Excellent



### Abrasion resistance

Excellent



### Application

Mooring, towing, offshore.

### Features

Mooring tails provide elasticity and shock/energy absorption within the mooring arrangement and prevent damages to primary mooring line. Used especially in combination with steel or UHMWPE ropes.

Diameter (mm)	Length (m)	Wt/tail (kg)	Breaking strength (t)	LDBF MEG4 (t)
60	11	37	73.5	66.15
64	11	42	84.1	75.69
68	11	48	93.7	84.33
72	11	54	103.8	93.42
76	11	60	115	103.5
80	11	65	127.7	114.93
88	11	95	158	142.2

All products are produced in accordance with OCIMF guidelines and IACS approved

## Protection sleeves



### Features

- ▶ Improves rope lifespan
- ▶ Easily installed using extra durable velcro lining
- ▶ Lightweight, with a smooth surface
- ▶ Excellent UV and heat resistance
- ▶ Customized sizes
- ▶ Suitable for all fiber ropes

Rope size (mm)	Width (mm)	Length (mm)
20-40	250	3000
44-64	350	3000
68-96	500	3000

## Mooring links



### Features

- ▶ Connection between wire rope and fiber tail
- ▶ Galvanized steel
- ▶ Compact design

Link 90 T Tail 56-68 mm	Link 120 T Tail 72-80 mm
----------------------------	-----------------------------

Breaking load: 90 T  
Proof load: 45 Tonnes  
Weight: 11,2 kg

Breaking load: 120 T  
Proof load: 60 Tonnes  
Weight: 16,9 kg

Link 180 T Tail 88-112 mm	Link 300 T Tail 88-112 mm
------------------------------	------------------------------

Breaking load: 90 T  
Proof load: 45 Tonnes  
Weight: 11,2 kg

Breaking load: 120 T  
Proof load: 60 Tonnes  
Weight: 16,9 kg

# Steel wire ropes

**General purpose wire rope 6×36 WS+FC**

Application: multipurpose



**General purpose wire rope 6×36 WS+IWRC**

Application: multipurpose



**Poweract 4 4x36**

Application: high lifting tower cranes



**SES Swaged 4x39**

Application: cranes, cargo lifting, hoisting



**Non-rotating wire rope 19x7 WSC**

Application: multipurpose, safety launching appliances



**Non-rotating wire rope 35x7 WSC**

Application: multipurpose, safety launching appliances

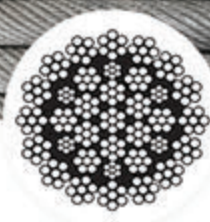

**Compacted non-rotating wire rope 35x7 WSC**

Application: multipurpose

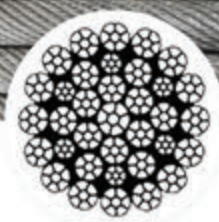

**General purpose wire rope 6×19 WS+FC**

Application: general purpose, fishing, slings, winch and hoist ropes, construction

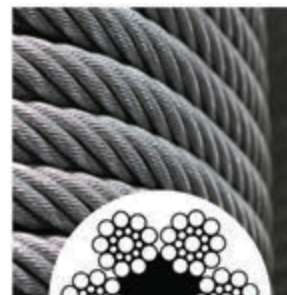

**General purpose wire rope 6×19 WS+IWRC**

Application: general purpose, fishing, slings, winch and hoist ropes, construction



**Galvanized steel wire rope 3×31 WS**

Application: trawl warp. Bottom trawling: upper/lower bridles, sweepline, headline

All products are IACS approved

## Fitting eyes using our 600 t press



## Tensile test using our own test bed



All products are IACS approved

## Steel wire rope products

---



- ▶ Hoisting
- ▶ Luffing
- ▶ Lifting
- ▶ DNV certification upon request

Thimbles DIN & JIS standards





**VIPER Wire Rope Lubricator** is a safer & faster method to take care of your mooring ropes. This automatic application cleans all outer contamination and lubricates steel wire ropes in one pass.

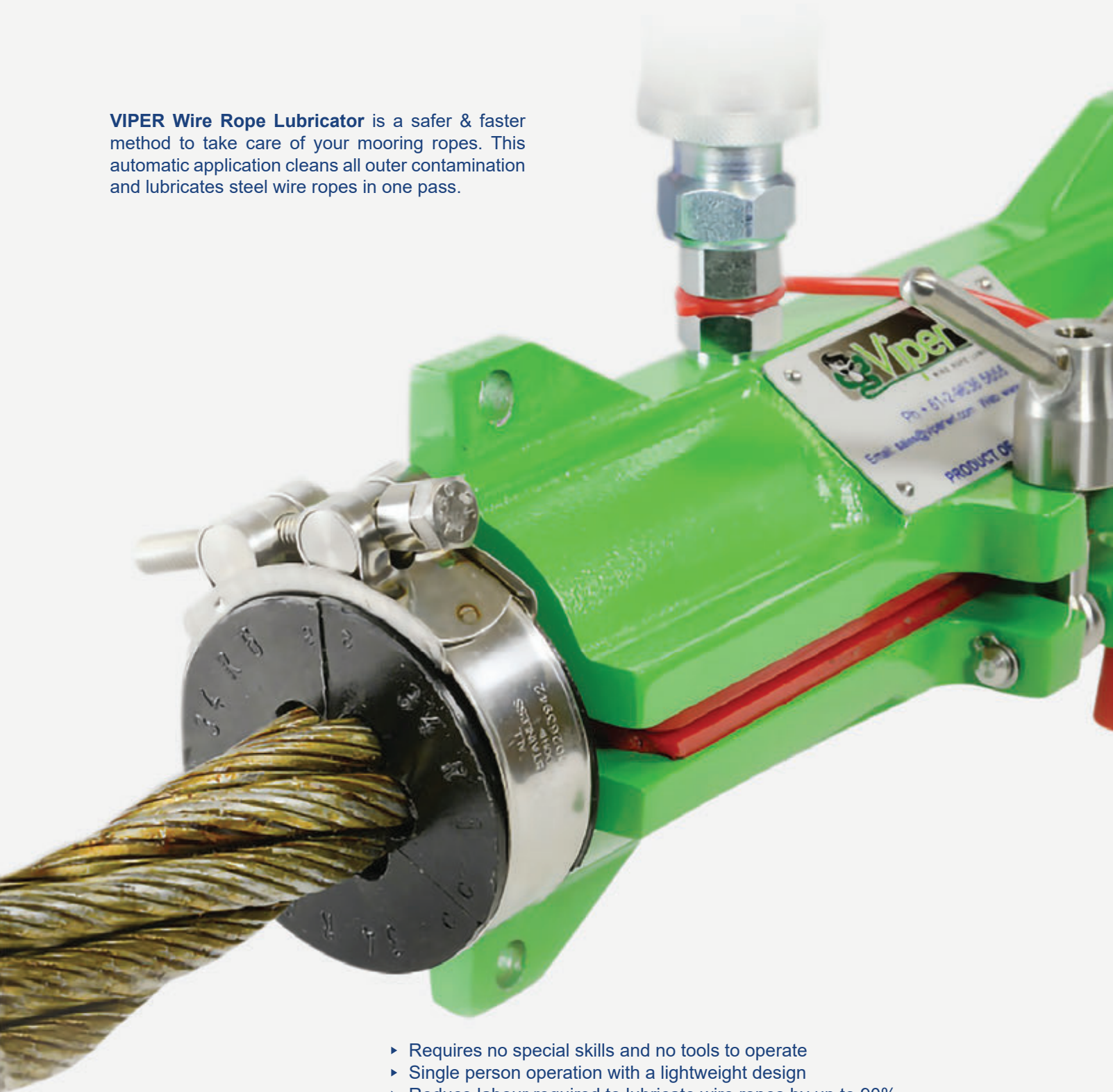

- ▶ Requires no special skills and no tools to operate
- ▶ Single person operation with a lightweight design
- ▶ Reduce labour required to lubricate wire ropes by up to 90%
- ▶ Grease up to 2000m of rope per hour
- ▶ Increase wire rope life up to 300%
- ▶ Light weight, easy to install and operate
- ▶ Unlike the manual method, operators have no direct contact with the lubricant
- ▶ All excess lubricant is captured and may be re-used, no wastage

An official distributor



Sale & rental

## Anchors

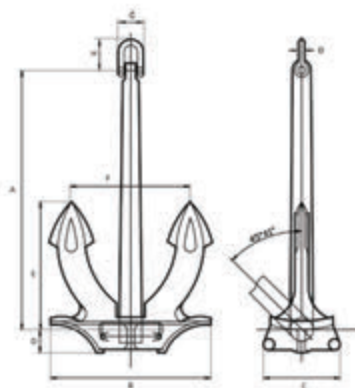

Stockless Anchor type "HALL"

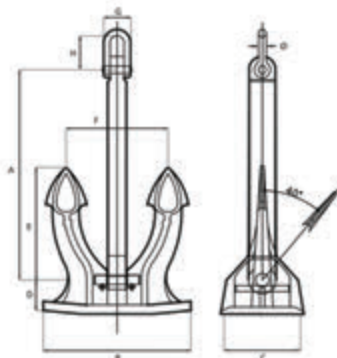

Stockless Anchor type "SPEK"

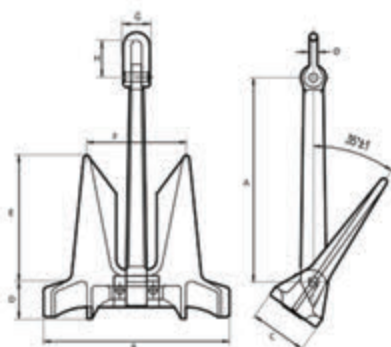

High Holding Power Anchor type "AC-14"

## Chain accessories

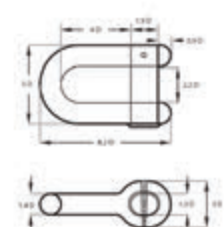

End Shackle type D



Swivel Forerunner

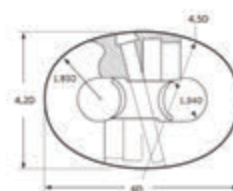

Joining Shackle Type Kenter

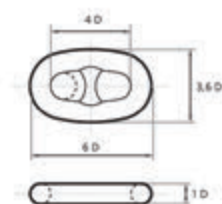

Common link

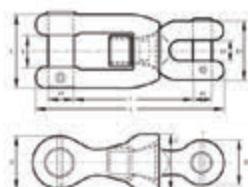

Swivel Shackle type B

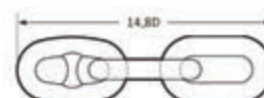

3 Link Adaptor

All products are IACS approved



Diam (mm)	Stud link Chain (27,5mtr) weights	3-Link Adaptor (E+EL+C) (kgs)	Joining Shackle Type Kenter (kgs)	End Shackle Type D (kgs)	Swivel-Forerunner (E+EL+SW + EL+C) (kgs)	Proof load (kN)	Breaking load (kN)
16	160	1.37	0.62	1.6	3.57	-	-
17.5	193	1.89	0.82	2.0	4.73	-	-
19	223	2.37	1.00	2.5	5.75	-	-
20.5	275	2.98	1.35	3.3	7.18	244	349
22	305	3.46	1.6	4.0	8.21	280	401
24	366	4.68	2.0	5.0	11.38	332	476
26	432	5.9	2.7	6.0	14.05	389	556
28	503	7.6	3.3	8.0	17.9	449	642
30	578	8.9	3.9	9.5	21.1	514	735
32	657	10.8	4.6	12.0	25.7	583	833
34	743	13.1	5.8	14.0	31.3	655	937
36	831	15.4	6.6	17.0	36.9	732	1050
38	927	17.6	7.8	20.0	42.7	812	1160
40	1020	20.8	9.1	23.0	50.7	896	1280
42	1114	24.4	10.5	26.0	59.8	981	1400
44	1218	28.6	12.2	29.0	70.6	1080	1540
46	1334	33.0	14.0	33.0	81.5	1170	1680
48	1452	37.9	16.0	37.0	95.0	1270	1810
50	1568	43	18	41	115	1370	1960
52	1705	50	20	45	124	1480	2110
54	1815	55	20	50	141	1590	2270
56	1953	60	24	54	148	1710	2430
58	2118	65	28	65	168	1810	2600
60	2283	71	28	70	191	1940	2770
62	2420	79	33	76	202	2060	2940
64	2585	88	38	82	231	2190	3130
66	2750	97	38	94	261	2310	3300
68	2943	106	44	101	273	2450	3500
70	3135	115	44	108	307	2580	3690
73	3410	131	51	124	348	2790	3990
76	3713	148	58	141	392	3010	4300
78	3905	160	65	150	409	3160	4500

All products are IACS approved

### Anode K3



No.	Dimension (mm)				Zinc (ZnAlCd) Mass (kg)		Aluminium (AlZnIn) Mass (kg)	
	l	h	a	c	Gross	Nett	Gross	Nett
1	130	25	60	100	1.08	1.00	0.52	0.45
2	150	30	80	220	2.15	1.90	0.97	0.75
3	250	30	80	320	3.40	3.10	1.57	1.30
4	250	40	100	320	5.50	5.10	2.45	2.05

### Anode K5



ATTENTION: anodes K5 of dimension 8-11 are equipped with insert size 40x8 mm

No.	Dimension (mm)				Zinc (ZnAlCd) Mass (kg)		Aluminium (AlZnIn) Mass (kg)	
	l	h	a	c	Gross	Nett	Gross	Nett
1	400	40	125	460	10.50	9.95	4.00	3.45
2	450	40	125	510	12.00	11.35	5.00	4.35
3	550	45	125	610	16.00	15.25	6.50	5.75
4	650	45	125	710	21.00	20.10	8.00	7.10
5	800	50	125	860	27.00	25.95	11.50	10.45
6	900	50	125	960	30.00	28.80	13.00	11.80
7	1200	50	125	1280	40.00	38.40	18.00	16.40
8	800	50	150	880	-	-	18.00	16.30
9	950	50	150	1030	-	-	21.00	19.20
10	1050	65	150	1130	-	-	30.00	27.60
11	1200	65	150	1280	-	-	34.00	31.60

### Zinc anodes alloy

Alloying elements (%)	Maximum impurities (%)	Electrochemical parameters AZn acc to DNV RP B401: TESTA	
Al 0.12 - 0.18	Fe 0.005	Closed circuit potential acc Ag/AgCl	1030 mV
Cd 0.05 - 0.10	Pb 0.005	Consumption rate	11.2 kg/A*yr
Zn - balance	Cu 0.002	Capacity	780 A*h/kg
	Sn 0.002		

### Aluminum anodes alloy

Alloying elements (%)	Maximum impurities (%)	Electrochemical parameters acc to DNV RP B401 test B (96H)	
Zn 3.0-3.5	Fe 0.029-0.09	Closed circuit potential	1090mV
In 0.016-0.040	Si 0.034-0.10	Consumption Rate	3.5 kg/A*r
Al Remaining	Cu 0.0011-0.005	Capacity	2650A*h/kg

All products are Mill certificated 3.1B/

## Isophthalic gratings

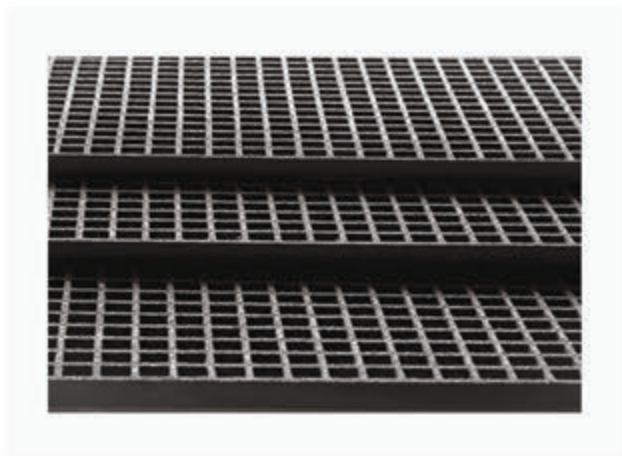

### Features

- ▶ Easy to handle
- ▶ Lighter than steel
- ▶ Non-corrosive
- ▶ Do not require painting
- ▶ Superior grip
- ▶ Slip resistance

### Application

- ▶ Marine
- ▶ Offshore
- ▶ Transportation
- ▶ Industrial

### Connection clips

M - type

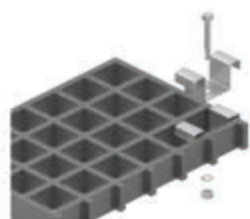

J - type

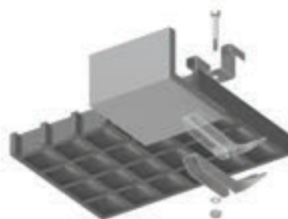

Panel Thickness (mm)	Panel size (mm)	Mesh size (mm)
25	Standard: 1000x2000	25x100
30	Panels can be cut to any size according to requirements	38x38
38		

Material	Operation temperature	Corrosion and chemical resistant
Isophthalic polyester resin	-50 - 90 °C	Industrial
Vinylester resin	-50 - 110 °C	Superior



All products are IACS approved

## Phenolic gratings



### Types

- ▶ Pultruded
- ▶ Molded
- ▶ Galvanized steel  
(available on special request)

### Features

- ▶ Superior fire safety characteristics
- ▶ Long service life
- ▶ Low maintenance
- ▶ High strength to weight ratio
- ▶ Slip resistance
- ▶ High corrosion resistance
- ▶ Low installations cost

### Application

- ▶ Marine
- ▶ Offshore
- ▶ Transportation
- ▶ Industrial

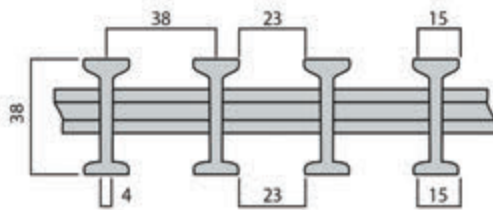

	Open area	Load bar	Top and bandwidth	Weight (kg)
1-6015	60	3B	15/15	14.4



All products are IACS approved

DIN & JIS standards



Body	Steam/seat	Flange Dimensions	Pressure Rating	Temp. Range	Upon Request
Cast iron, ductile iron, cast steel, marine bronze Rg5, stainless steel	Marine bronze Rg5, stainless steel	DIN flanges acc.to (DIN 5201)JIS flanges acc.to 5K/10K/16K/20K	PN4-PN40/ 5K-40K	-10C...+300C -10C...+400C	IACS certificate

All products are Mill certificated 3.1B/

## Slip-on & blind type

		DIN					JIS			
DN		PN06	PN10	PN16	PN25	PN40	5K	10K	16K	40K
15	D	80	95	95	95	95	80	95	95	115
	PCD holes	55 4x11	65 4x14	65 4x14	65 4x14	65 4x14	60 4x12	70 4x15	70 4x15	80 4x19
20	D	90	105	105	105	105	85	100	100	120
	PCD holes	65 4x11	75 4x14	75 4x14	75 4x14	75 4x14	65 4x12	75 4x15	75 4x15	85 4x19
25	D	100	115	115	115	115	95	125	125	130
	PCD holes	75 4x11	85 4x14	85 4x14	85 4x14	85 4x14	75 4x12	90 4x19	90 4x19	95 4x19
32	D	120	140	140	140	140	115	135	135	140
	PCD holes	90 4x14	100 4x18	100 4x18	100 4x18	100 4x18	90 4x15	100 4x19	100 4x19	105 4x19
40	D	130	150	150	150	150	120	140	140	160
	PCD holes	100 4x14	110 4x18	110 4x18	110 4x18	110 4x18	95 4x15	105 4x19	105 4x19	120 4x23
50	D	140	165	165	165	165	130	155	155	165
	PCD holes	110 4x14	125 4x18	125 4x18	125 4x18	125 4x18	105 4x15	120 4x19	120 8x19	130 8x19
65	D	160	185	185	185	185	155	175	175	200
	PCD holes	130 4x14	145 4x18	145 4x18	145 8x18	145 8x18	130 4x15	140 4x19	140 8x19	160 8x23
80	D	190	200	200	200	200	180	185	200	210
	PCD holes	150 4x18	160 8x18	160 8x18	160 8x18	160 8x18	145 4x19	150 8x19	160 8x23	170 8x23
100	D	210	220	220	235	235	200	210	225	250
	PCD holes	170 4x18	180 8x18	180 8x18	190 8x22	190 8x22	165 8x19	175 8x19	185 8x23	205 8x25
125	D	240	250	250	270	270	235	250	270	300
	PCD holes	200 8x18	210 8x18	210 8x18	220 8x26	220 8x26	200 8x19	210 8x23	225 8x25	250 8x27
150	D	265	285	285	300	300	265	280	305	355
	PCD holes	225 8x18	240 8x22	240 8x22	250 8x26	250 8x26	230 8x19	240 8x23	260 12x25	295 12x33
200	D	320	340	340	360	375	320	330	350	405
	PCD holes	280 8x18	295 8x22	295 12x22	310 12x26	320 12x30	280 8x23	290 12x23	305 12x25	345 12x33
250	D	375	395	405	425	450	385	400	430	475
	PCD holes	335 12x18	350 12x22	355 12x26	370 12x30	385 12x33	345 12x23	355 12x25	380 12x27	410 12x33
300	D	440	445	460	485	515	430	445	480	540
	PCD holes	395 12x22	400 12x22	410 12x26	430 16x30	450 16x33	390 12x23	400 16x25	430 16x27	470 16x39
350	D	490	505	520	555	580	480	490	540	585
	PCD holes	445 12x22	460 16x22	470 16x26	490 16x33	510 16x36	435 12x25	445 16x25	480 16x33	515 16x39

All products are Mill certificated 3.1B/



## Size 50A-80A



DN	H	H1
50	175	174
65	204	207
80	244	240

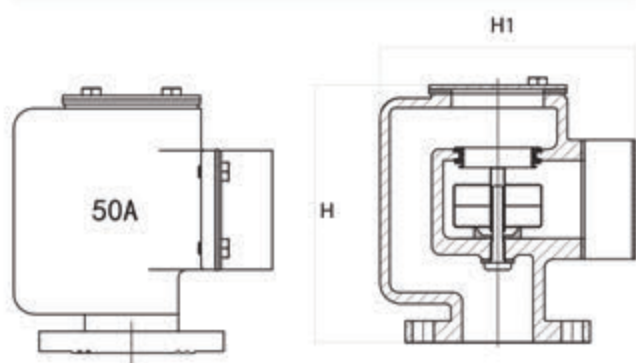

## Size 100A-450A



DN	F	H
100	246	220
125	284	250
150	326	285
200	428	365
250	542	430
300	612	530

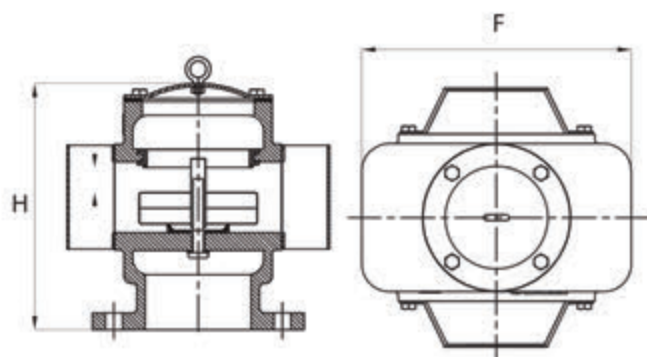

All products are Mill certificated 3.1B/

### Products & services

- ▶ Packing foil
  - ▶ Banding strap
  - ▶ Separation nets
  - ▶ Pneumatic rubber fender
  - ▶ UHMWPE rope for trawling
  - ▶ STS operation rope
  - ▶ Steel wire rope 3x13 WS
  - ▶ Steel wire rope 6x19WS+IWRC/FC
- ▶ Quarterly supply



CONTACT US TO FIND OUT MORE

HEAD OFFICE  
Pramones str. 8A  
LT-94102 Klaipeda, Lithuania

+370 46 411 911  
[pikasoma@garant.eu](mailto:pikasoma@garant.eu)



ROTTERDAM

SINGAPORE

HOUSTON

MONTREAL

BUSAN

KLAIPĖDA

RIGA

LAS PALMAS